

THE OXFORD SCIENCE PARK

THE SADLER BUILDING - SERVICED OFFICES



- Serviced offices on flexible leasing packages
- 1,300 to 6,150 sq ft (120 - 569 sq m)
- Suitable for up to four companies
- Located above the new Sadler Brasserie

THE SADLER BUILDING - SERVICED OFFICES

The Sadler Building - Serviced Offices

The Sadler building is designed as a focal point of the Science Park and the ground floor includes the Sadler Brasserie and a range of meeting rooms.

The first floor offers a choice of four offices available on a simple monthly licence agreement. The offices have an open B1 planning consent and are suitable for either science and technology based companies or for general office use.

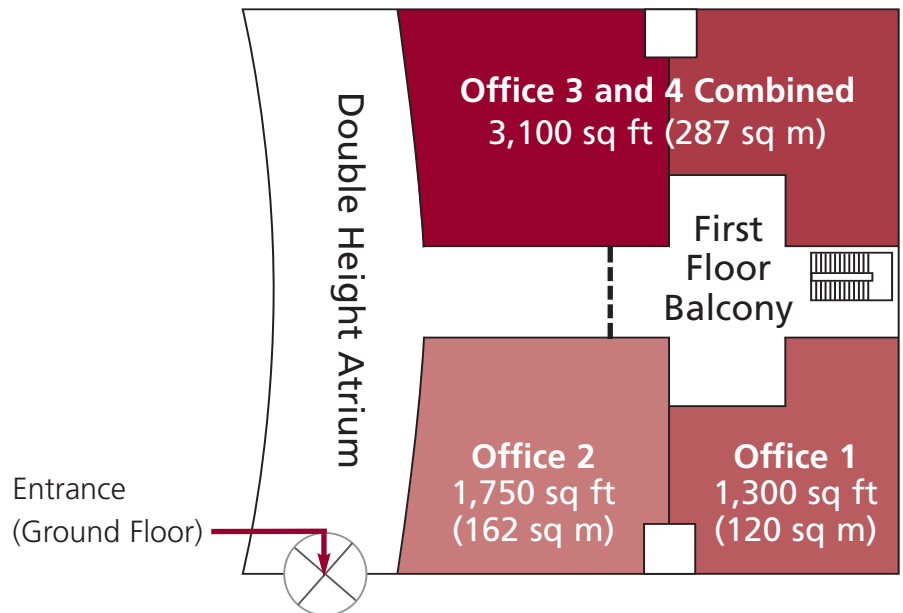

Monthly licence fee includes:

- Business rates
- Water rates
- Park service charge
- Reception service
- Broadband internet connection
- Category 5e cabling
- Telephone line rental
- Voicemail
- Franking of mail
- Parking and visitor parking
- Park security
- Web Site listing

The Oxford Science Park

On historic Oxford's doorstep, The Oxford Science Park is thriving as a distinctive contemporary location for companies of all sizes. Located just 3 miles from Oxford City Centre the Park has excellent road and rail links, offering easy access to London and its international airports.

Since development began in 1991, the Park has evolved into a dynamic and vibrant community in which companies enjoy a high quality and attractive working environment. Over half a million square feet of business and laboratory accommodation has been completed and work on a new phase of developments is underway.

Park services and facilities include:

- On-site nursery
- Regular bus service
- Conference rooms
- 4 Sadler meeting rooms
- 8 Magdalen Centre meeting rooms
- Coffee bars
- Admin. support
- Car valet service
- ATM cash machine
- Recycling services
- Dry cleaning service
- Park newsletters

For further information contact:

Shannon Blaszkowski, The Magdalen Centre,
The Oxford Science Park

Tel: (01865) 784000

E-mail: Shannon.Blaszkowski@oxfordsp.com



www.oxfordsp.com

The Oxford Science Park gives notice that (i) these particulars are set out as a general outline only, for the guidance of intended purchasers or lessees, and do not constitute, nor constitute part of, any offer or contract; (ii) all descriptions, dimensions, references to condition and necessary permissions for use and occupation, and other details are given without responsibility, and any purchasers or tenants should not rely on them as statements or representations of fact, but must satisfy themselves by inspection or otherwise as to the correctness of each of them; (iii) Unless otherwise stated all rents and prices quoted are exclusive of VAT which may be payable in addition.

The Oxford Science Park supports The Code for Leasing Business Premises in England and Wales 2007, produced by The Joint Working Group on Commercial Leases. Follow the Lease Code at www.commercialleasecode.co.uk. Small Business? For free help on negotiating a lease see www.leasebusinesspremisses.co.uk.



Printed on Revive 50:50 from the Robert Home Group, which is produced using 50% recovered fibre and 50% virgin wood fibre. Manufactured at a mill that has been awarded the ISO14001 certificate for environmental management. The pulp is bleached using an elemental chlorine free (ECF) process. The lamination used on this brochure is fully recyclable.

11 West Way
Oxford OX2 0QL

savills.com

savills

01865 269000

aparker@savills.com

20 Grosvenor Hill
London W1K 3HQ

020 7499 8644

tmellows@savills.com